

**DEVELOPER CONTRACT PLAN
WORK-AS-CREATED**

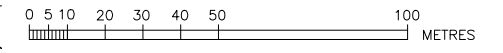

- NOTES:
- WATER SERVICING COORDINATOR, SURVEY & DESIGNER:
CALBRE CONSULTING (NSW) PTY LTD
P.O. BOX 8300 Baulkham Hills BC NSW 2153
PH: (02) 8808 5000
FOR:
NORTH RICHMOND JOINT VENTURE
PO BOX 1918
PENRITH NSW 2750
PH: (02) 4760 1400
 - THE WORKS AND MATERIAL ARE IN ACCORDANCE WITH THE SEWER RETICULATION CODE OF AUSTRALIA (WSA 02-2002-2.2 VERSION 4).
 - ALL LOTS WERE VACANT AT TIME OF SURVEY.
 - ALL STRUCTURES CONSTRUCTED TO PROPOSED FINISHED SURFACE LEVELS.
 - PIPES CONCRETE ENCASED SHOWN ACCORDINGLY: ALL ENCASED SUPPORT TYPE 12U (UNLESS INDICATED 12R)
 - ALL LEVELS ELECTRONICALLY GENERATED. NO LEVEL BOOK AVAILABLE.
 - ALL MAINS LAID IN EXISTING, PROPOSED OR FUTURE ROAD CARRIAGEWAYS - SEE SITE SPECIFIC COMPACTION SPECIFICATION - REFER SHEET 2
 - CONCRETE BULKHEADS CONSTRUCTED AT REAR OF KERB FOR ALL ROAD CROSSINGS. REFER STD DWG SEW-1206 & SEW-1207-V.
 - THE MINIMUM NUMBER OF FIELD COMPACTION TESTS REQUIRED TO SATISFY THE SEWERAGE CODE OF AUSTRALIA (CLAUSE 22.3.4.4) ARE:
PIPE EMBEDMENT ZONE: - NIL TRENCH FILL ZONE - TRAFFICABLE: NIL (SEE NOTE 7) (SEE NOTE 11)
TRENCH FILL ZONE - NON-TRAFFICABLE: 120 M.H. & M.S. ZONE: 260
(PLEASE REFER TO SITE SPECIFIC COMPACTION SPECIFICATION - REFER SHEET 2)
 - ALL PROPERTY CONNECTION SEWERS CONSTRUCTED AS DETAILED IN DTC-2120.
 - EMBEDMENT COMPACTION TESTING AS PER SITE SPECIFIC COMPACTION SPECIFICATION (REFER SHEET 2) AND SUBJECT TO CLAUSE 22.3.3.1 OF SEWERAGE CODE OF AUSTRALIA. SELF-COMPACTING METAL GRANULAR EMBEDMENT WAS USED.
 - WHERE MAINTENANCE SHAFTS HAD A DEFLECTION GREATER THAN 30 DEGREES, INSTALLED 'POO PIT' TYPE OR APPROVED EQUIVALENT, THE DEFLECTION ANGLE (D.A.) FOR EACH MAINTENANCE SHAFT IS SHOWN ON THE SECTION.
 - ALL DN1050 M.H.'S CONSTRUCTED IN ACCORDANCE WITH DTC-2203, DTC-2220, DTC-2221 & DTC-2222 UNLESS INDICATED OTHERWISE.
 - MINIMUM ALLOWABLE BEARING PRESSURE OF FOUNDATION MATERIAL FOR MAINTENANCE HOLES WAS 100KPA. FOUNDATION MATERIAL INSPECTED BY A SUITABLY EXPERIENCED GEOTECHNICAL ENGINEER PRIOR TO PLACING BLINDING CONCRETE. CERTIFICATION PROVIDED TO WSC.
 - ALL MAINTENANCE STRUCTURES LOCATED WITHIN THE ROAD RESERVE FITTED WITH CLASS 'D' TRAFFICABLE LID.

CONSTRUCTION NOTES
THE WORKS AS DETAILED HEREON CONSTRUCTED IN ACCORDANCE WITH:
1. THE SEWERAGE CODE OF AUSTRALIA - WSA 02-2002 SYDNEY WATER EDITION VERSION 4;
2. DEEMED TO COMPLY DRAWINGS DTC-2000 (ISS. C, 18/03/15), DTC-2120 (ISS. 18/03/15), DTC-2203 (ISS. C, 18/03/15), DTC-2220 (ISS. D, 18/03/15), DTC-2221 (ISS. B, 01/03/13), DTC-2222 (ISS. C, 18/03/15)
3. SITE SPECIFIC COMPACTION TESTS - REFER SHEET 2

P.C.S. PROVIDED FOR FUTURE LOT

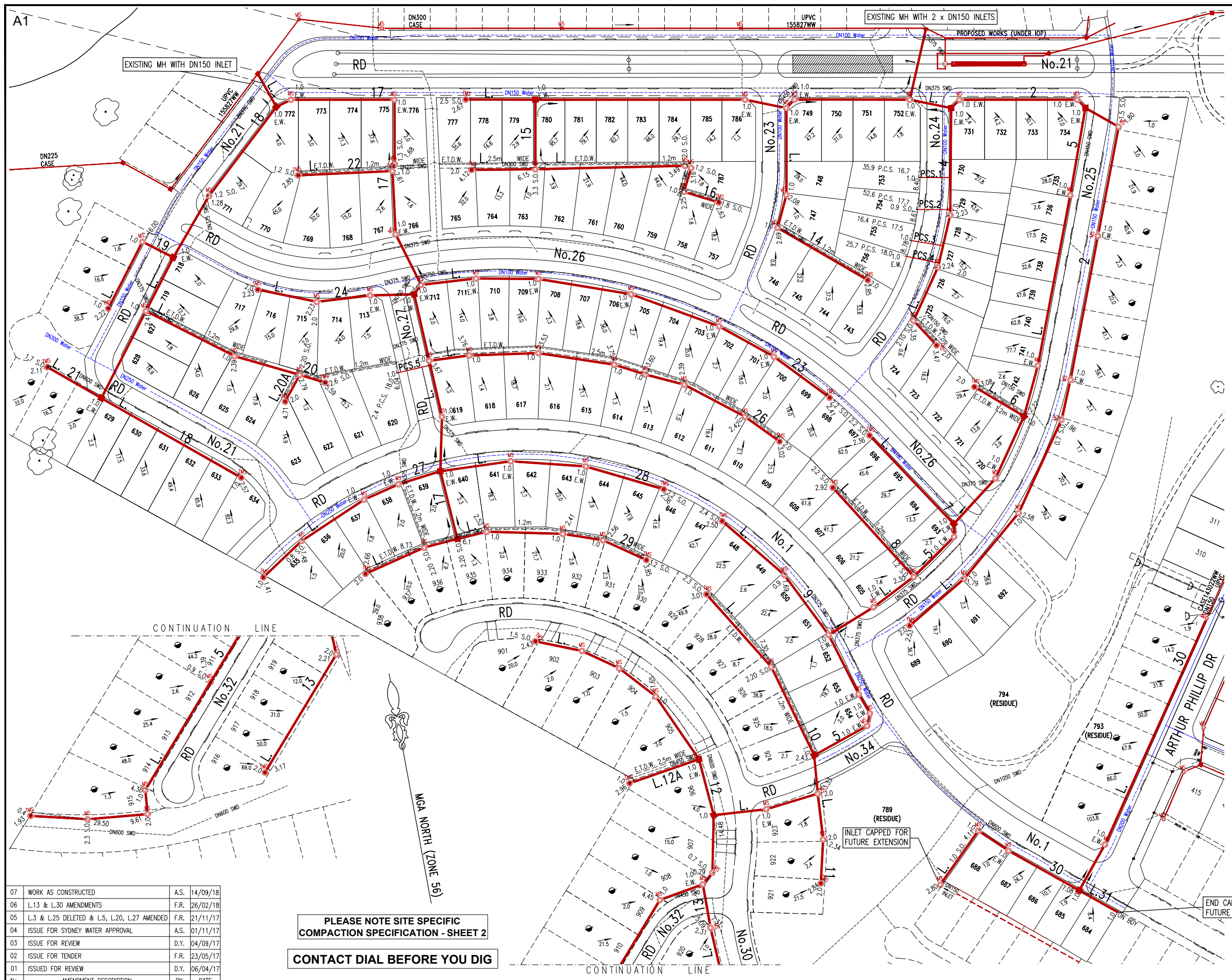

07	WORK AS CREATED	A.S.	14/09/18
06	L13 & L30 AMENDMENTS	F.R.	26/02/18
05	L3 & L25 DELETED & L5, L20, L27 AMENDED	F.R.	21/11/17
04	ISSUE FOR SYDNEY WATER APPROVAL	A.S.	01/11/17
03	ISSUE FOR REVIEW	D.Y.	04/09/17
02	ISSUE FOR TENDER	F.R.	23/05/17
01	ISSUED FOR REVIEW	D.Y.	06/04/17
No.	AMENDMENT DESCRIPTION	BY	DATE

**PLEASE NOTE SITE SPECIFIC
COMPACTION SPECIFICATION - SHEET 2
CONTACT DIAL BEFORE YOU DIG**

PLAN TO BE READ IN CONJUNCTION WITH CURRENT SYDNEY WATER STANDARDS SYDNEY WATER CORPORATION
PRIOR TO COMMENCEMENT OF EXCAVATION FOR PROPOSED AND EXISTING SERVICES CONTACT:
DIAL BEFORE YOU DIG Ph: 1100
ELECTRICITY ENDEAVOUR ENERGY Ph: 131 093
GAS TELSTRA Ph: 1300 880 906
TELECOMMUNICATIONS TELSTRA Ph: 1800 114 918
SYDNEY WATER Ph: 132 992
GIVING AT LEAST 48 HOURS NOTICE.

UTILITIES		TYPE		DATE		REF.	
WATER: DN100	Water	---	---	S.DATE	WAC/HYDRA	ELECTRICAL: E	---
PROP WATER: DN100	Water	---	---	S.DATE	DESIGN	PROP ELECTRICAL: E	---
STORMWATER: SMD	SMD	---	---	S.DATE	ENG.	RCWATER: RCWater	---
PROP STORMWATER: SMD	SMD	---	---	S.DATE	ENG.	PROP RCWATER: RCWater	---
GAS: G(LP)	G(LP)	---	---	S.DATE	D.B.Y.D.	SSM 58886 (ORIGIN)	19.04.17
PROP GAS: G(LP)	G(LP)	---	---	S.DATE	D.B.Y.D.	T.B.M. (ORIGIN)	19.04.17
TELSTRA: TEL	TEL	---	---	S.DATE	D.B.Y.D.	---	---
PROP TELSTRA: TEL	TEL	---	---	S.DATE	D.B.Y.D.	---	---

WORK AS CREATED CERTIFICATION			
DEVELOPER	NORTH RICHMOND JOINT VENTURE PTY LTD		
WATER SERVICE CO-ORDINATOR	CALBRE CONSULTING (NSW) PTY LTD		
CONSTRUCTOR	JONSHAN PTY LTD		
COMPLETED	13/09/2018	W.A.C. PREPARED	14/09/2018
DESIGNER	CALBRE CONSULTING (NSW) PTY LTD		
I CERTIFY THAT THE WORKS HAVE BEEN CONSTRUCTED IN ACCORDANCE WITH THE WORK AS CREATED DRAWINGS.			

PIPE SCHEDULE			
SIZE DN	TYPE	CLASS	LENGTH
150	U.P.V.C.	SN8	4519.46
RUBBER RING			
NO BOUNDARY TRAPS REQUIRED.			

NO AMENDMENTS ARE TO BE MADE TO THIS PLAN WITHOUT REFERENCE TO SYDNEY WATER. THIS PLAN IS NOT NECESSARILY UP TO DATE OR CORRECT AND SYDNEY WATER ACCEPTS NO RESPONSIBILITY.
U.B. DIRECTORY MAP 63/K12 41st Edition
SHEET 1 OF 6 File No. N/A

Sydney WATER SYDNEY WATER CORPORATION
Case No. 164471WW
HAWKESBURY SEWERAGE DRAINS TO NORTH RICHMOND S.T.W.

PLAN DRAWN DATE: 14/09/2018 VERSION: 07 SHEET 1 OF 6 SHEETS

L5
CONCRETE ENCASED

DEVELOPER CONTRACT PLAN
WORK-AS-CONSTRUCTED

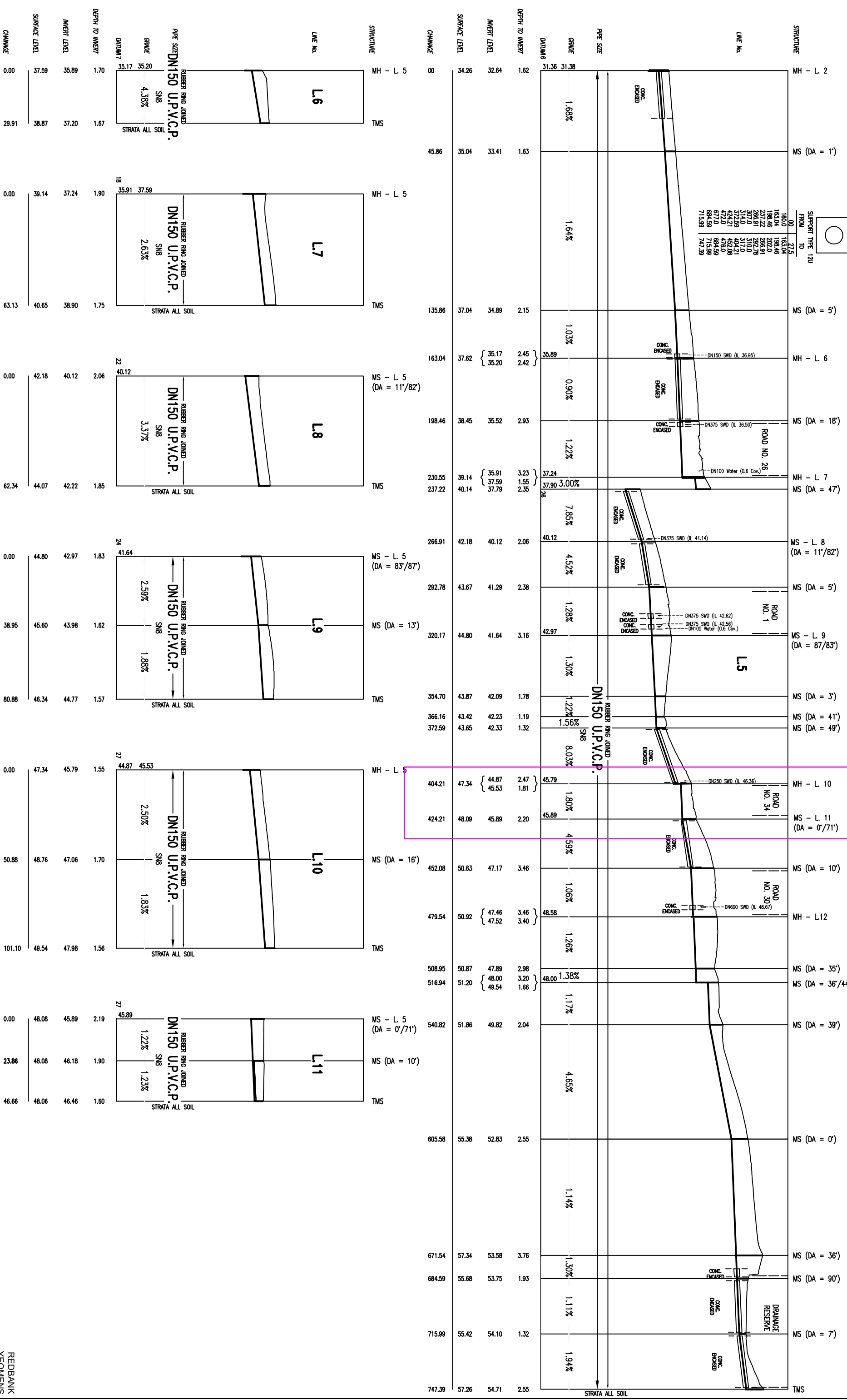

01	ISSUED FOR REVIEW	D.Y.	06/04/17
02	ISSUE FOR TENDER	F.R.	23/05/17
03	ISSUE FOR REVIEW	D.Y.	04/09/17
04	ISSUE FOR STONEY WATER APPROVAL	A.S.	01/11/17
05	L3 & L25 DETELED & L5, L20, L27 AMENDED	F.R.	21/11/17
06	L13 & L30 AMENDMENTS	F.R.	26/02/18
07	PRELIMINARY WORK AS CONSTRUCTED	A.S.	14/09/18

LINE No.	DEPTH TO INVERT	INVERT LEVEL	SURFACE LEVEL	CHANNICE
L.6	1.70	35.89	37.59	0.00
L.7	1.67	37.20	38.87	29.91
L.8	1.90	37.24	39.14	0.00
L.9	1.85	42.22	44.07	62.34
L.10	1.83	42.97	44.80	0.00
L.11	1.62	43.98	45.60	38.95
L.12	1.57	44.77	46.34	80.88
L.13	1.55	45.79	47.34	0.00
L.14	1.70	47.06	48.76	50.88
L.15	1.56	47.98	49.54	101.10
L.16	2.19	45.89	48.08	0.00
L.17	1.90	46.18	48.08	23.86
L.18	1.60	46.46	48.06	46.66

PLEASE NOTE SITE SPECIFIC
COMPACTION SPECIFICATION - SHEET 2
CONTACT DIAL BEFORE YOU DIG

WORK AS CONSTRUCTED CERTIFICATION

DEVELOPER: NORTH RICHMOND JOINT VENTURE PTY LTD
 W.S.C.: CALBRE CONSULTING (NSW) PTY LTD
 CONSTRUCTOR: JOHNSON PTY LTD
 COMPLETED: 13/09/2018
 W.A.C. PREPARED: 14/09/2018

DESIGNER: CALBRE CONSULTING (NSW) PTY LTD
 I CERTIFY THAT THE WORK HAS BEEN CONSTRUCTED IN ACCORDANCE WITH THE WORK AS CONSTRUCTED DRAWINGS

STONEY WATER CORPORATION
 REDBANK YEOMENS
 Case No. 164471WW SHT 3 OF 6 SHTS.

FOR DETAILS OF SERVICES SEE SHEET 1

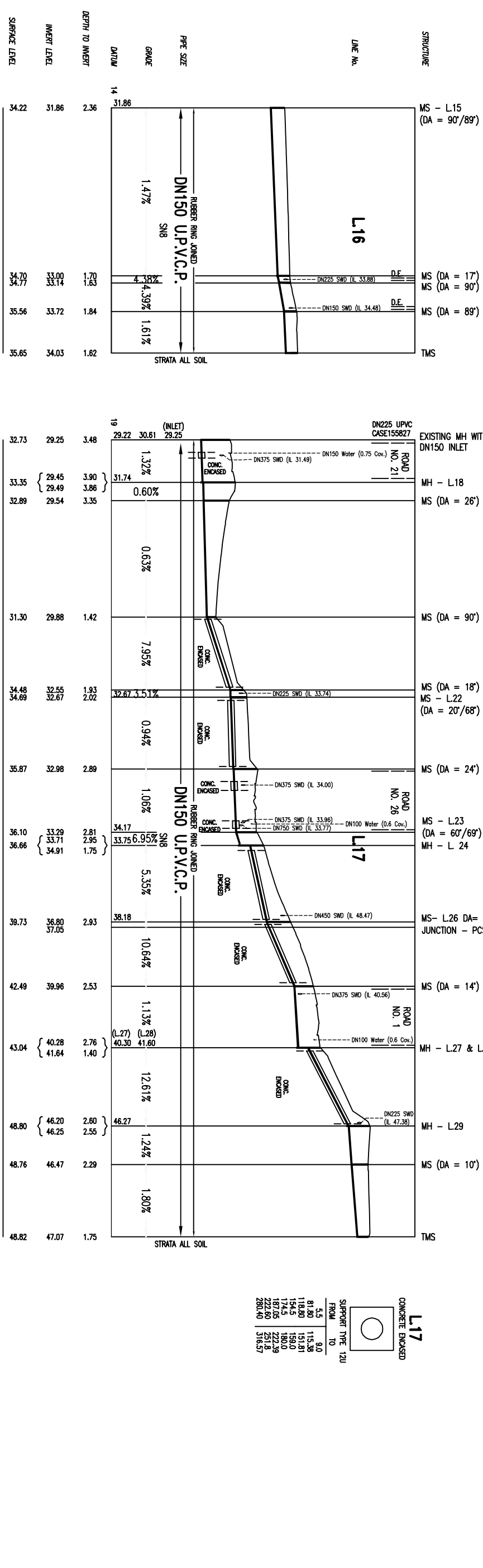
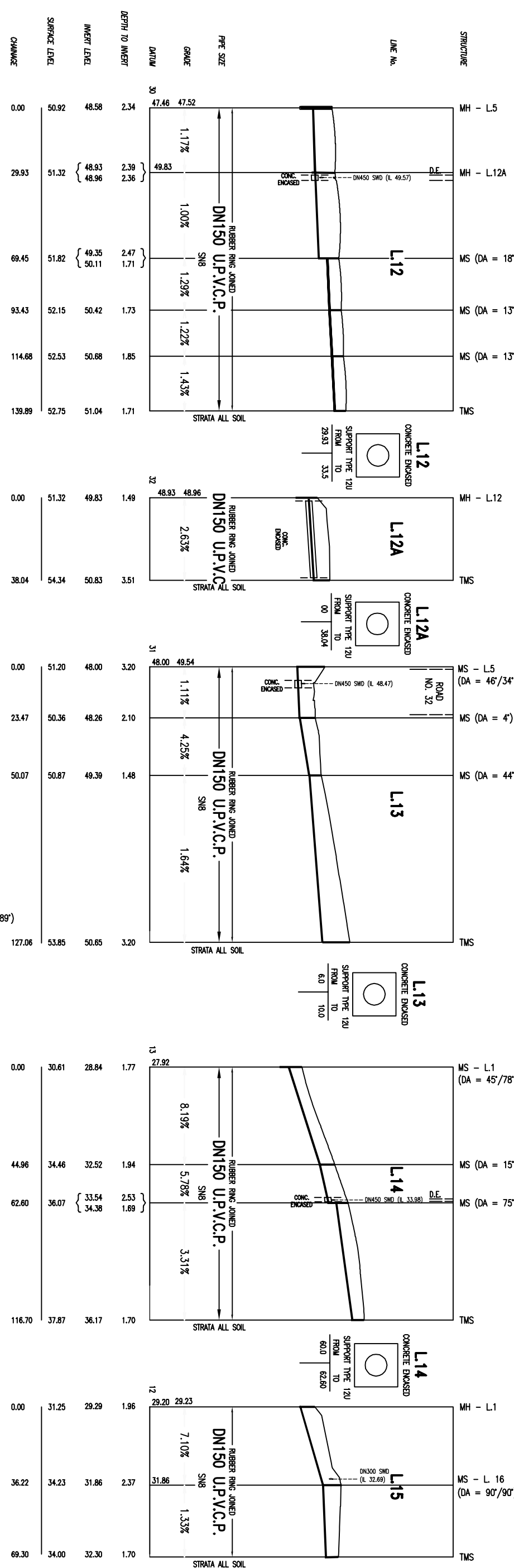

NO.	AMENDMENT DESCRIPTION	BY	DATE
01	ISSUED FOR REVIEW	D.Y.	06/04/17
02	ISSUE FOR TENDER	F.R.	23/05/17
03	ISSUE FOR REVIEW	D.Y.	04/09/17
04	ISSUE FOR STONEY WATER APPROVAL	A.S.	01/11/17
05	L3 & L26 DELETED & L5, L20, L27 AMENDED	F.R.	21/11/17
06	L13 & L30 AMENDMENTS	F.R.	26/02/18
07	WORK AS CONSTRUCTED	A.S.	14/09/18

PLEASE NOTE SITE SPECIFIC
COMPACTION SPECIFICATION - SHEET 2
CONTACT DIAL BEFORE YOU DIG

WORK AS CONSTRUCTED CERTIFICATION

DEVELOPER: NORTH RICHMOND JOINT VENTURE PTY LTD
W.S.C.: CALBRE CONSULTING (NSW) PTY LTD
CONTRACTOR: JOHNSON PTY LTD
COMPLETED: 13/09/2018
W.A.C. PREPARED: 14/09/2018

DESIGNER: CALBRE CONSULTING (NSW) PTY LTD
I CERTIFY THAT THE WORKS HAVE BEEN CONSTRUCTED IN ACCORDANCE WITH THE WORK AS CONSTRUCTED DRAWINGS

SYDNEY WATER CORPORATION
REDBANK
YEOMENS

Case No. 164471WW SHT 4 OF 6 SHTS.

FOR DETAILS OF SERVICES SEE SHEET 1

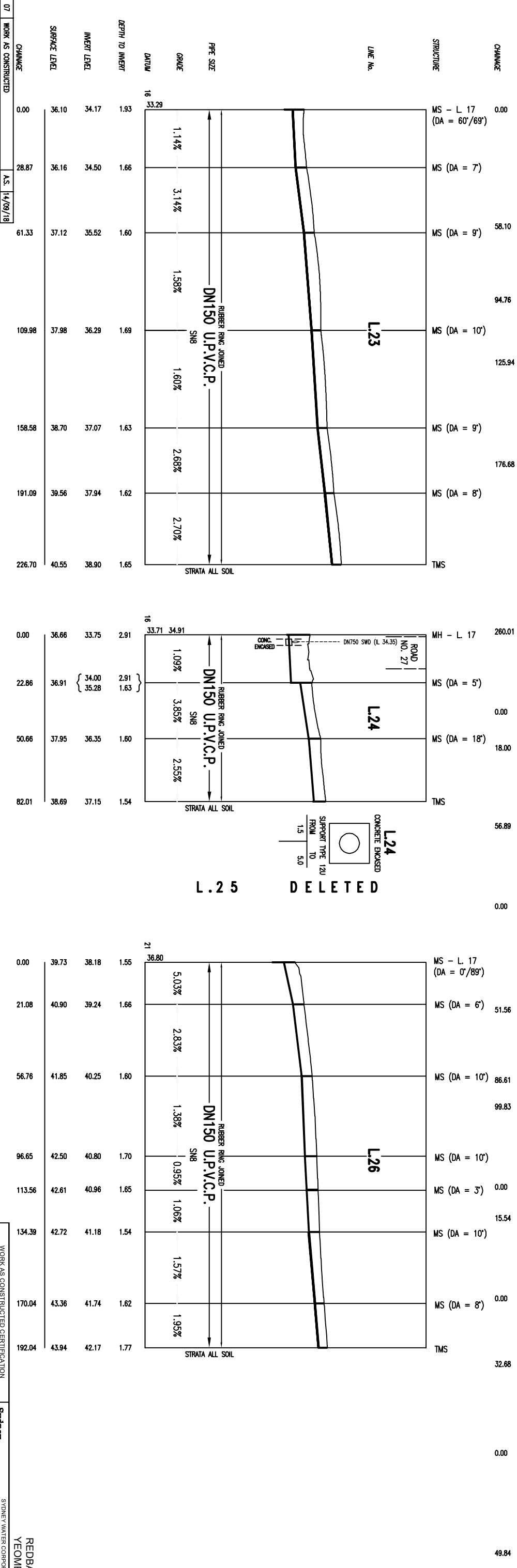
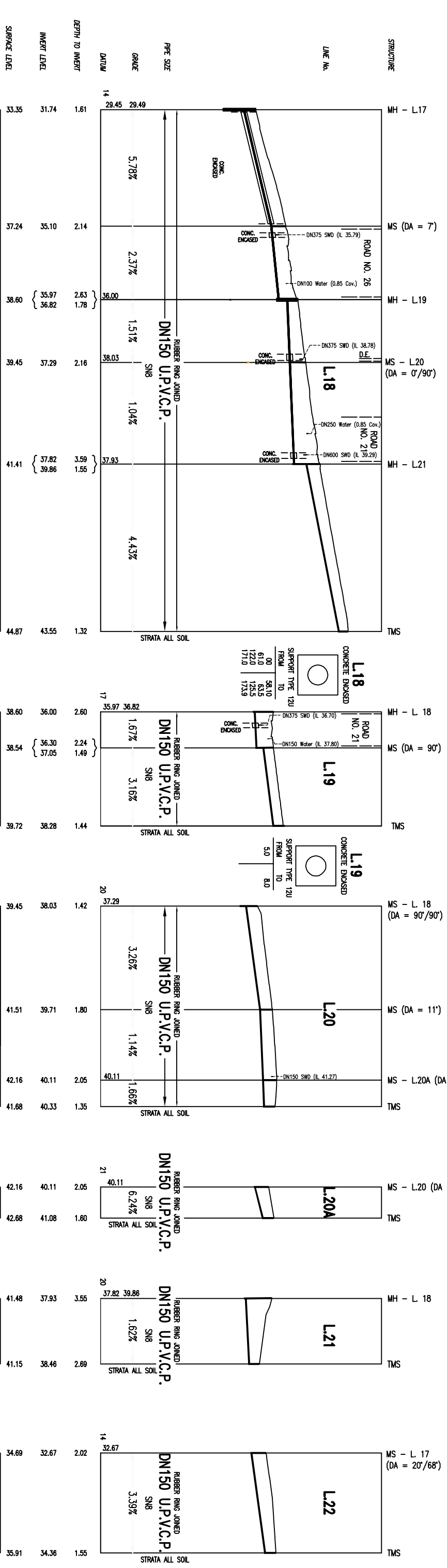

07	WORK AS CONSTRUCTED	A.S.	14/09/18
06	L13 & L30 AMENDMENTS	F.R.	26/02/18
05	L3 & L25 DELETED & L5, L20, L27 AMENDED	F.R.	21/11/17
04	ISSUE FOR STONEY WATER APPROVAL	A.S.	01/11/17
03	ISSUE FOR REVIEW	D.Y.	04/09/17
02	ISSUE FOR TENDER	F.R.	23/05/17
01	ISSUED FOR REVIEW	D.Y.	06/04/17
	AMENDMENT DESCRIPTION	BY	DATE

CHANGE

0.00 28.87 61.33 109.98 158.58 191.09 226.70

36.10 36.16 37.12 37.98 38.70 39.56 40.55

34.17 34.50 35.52 36.29 37.07 37.94 38.90

1.93 1.66 1.60 1.69 1.63 1.62 1.65

DEPTH TO INVERT

INVERT LEVEL

34.17 34.50 35.52 36.29 37.07 37.94 38.90

36.10 36.16 37.12 37.98 38.70 39.56 40.55

SURFACE LEVEL

CHANGE

0.00 28.87 61.33 109.98 158.58 191.09 226.70

36.66 36.91 37.95 38.69

33.75 33.75 36.35 37.15

2.91 2.91 1.60 1.54

DEPTH TO INVERT

INVERT LEVEL

33.75 33.75 36.35 37.15

36.66 36.91 37.95 38.69

SURFACE LEVEL

CHANGE

0.00 21.08 56.76 96.65 113.56 134.39 170.04 192.04

39.73 40.90 41.85 42.50 42.61 42.72 43.36 43.94

38.18 39.24 40.25 40.80 40.96 41.18 41.74 42.17

1.55 1.66 1.60 1.70 1.65 1.54 1.62 1.77

DEPTH TO INVERT

INVERT LEVEL

38.18 39.24 40.25 40.80 40.96 41.18 41.74 42.17

39.73 40.90 41.85 42.50 42.61 42.72 43.36 43.94

SURFACE LEVEL

PLEASE NOTE SITE SPECIFIC
COMPACTION SPECIFICATION - SHEET 2

CONTACT DIAL BEFORE YOU DIG

WORK AS CONSTRUCTED CERTIFICATION

DEVELOPER NORTH RICHMOND JOINT VENTURE PTY LTD

W.S.C. CALBRE CONSULTING (NSW) PTY LTD

CONSTRUCTOR JONSHAW PTY LTD

COMPLETED 13/09/2018

W.A.C. PREPARED 14/09/2018

DESIGNER CALBRE CONSULTING (NSW) PTY LTD

I CERTIFY THAT THE WORKS HAVE BEEN CONSTRUCTED IN ACCORDANCE WITH THE WORK AS CONSTRUCTED DRAWINGS.

STONEY WATER CORPORATION

REDBANK YEOMENS

SYDNEY WATER CORPORATION

FOR DETAILS OF SERVICES SEE SHEET 1

Case No. 164471WW SHT 5 OF 6 SHTS

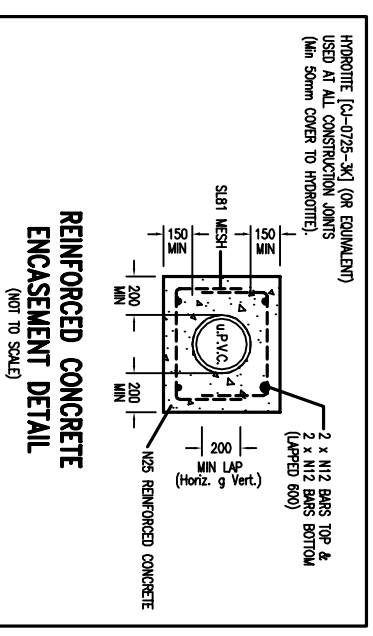
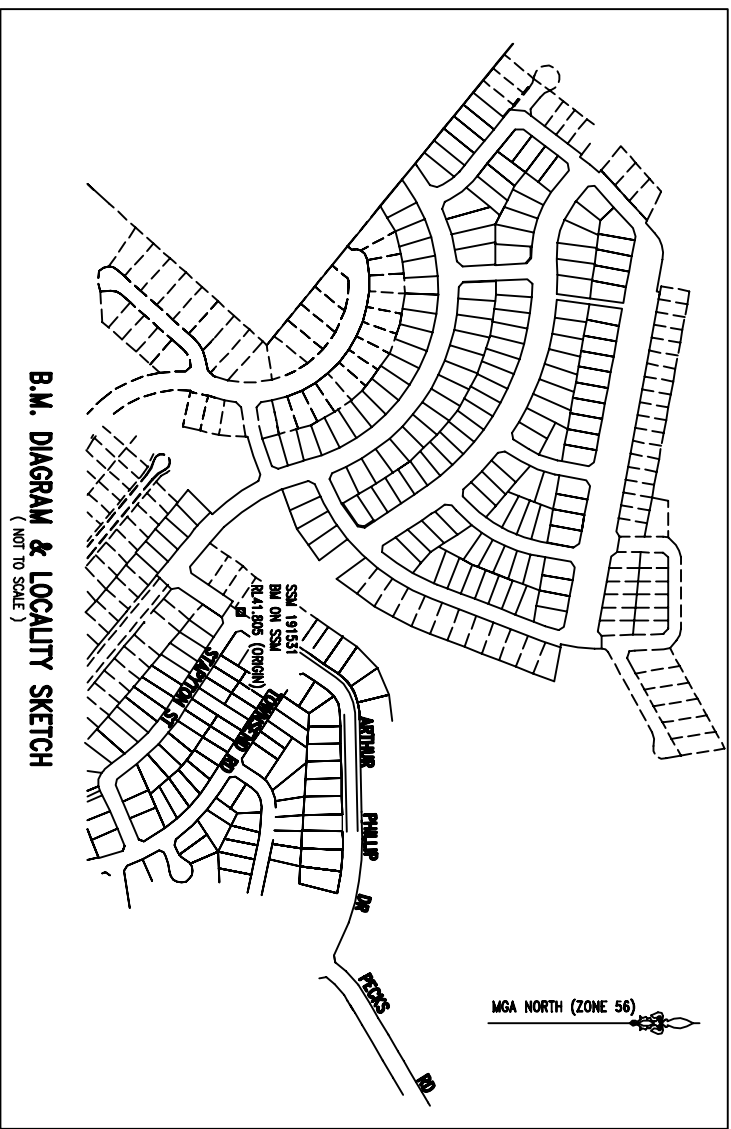
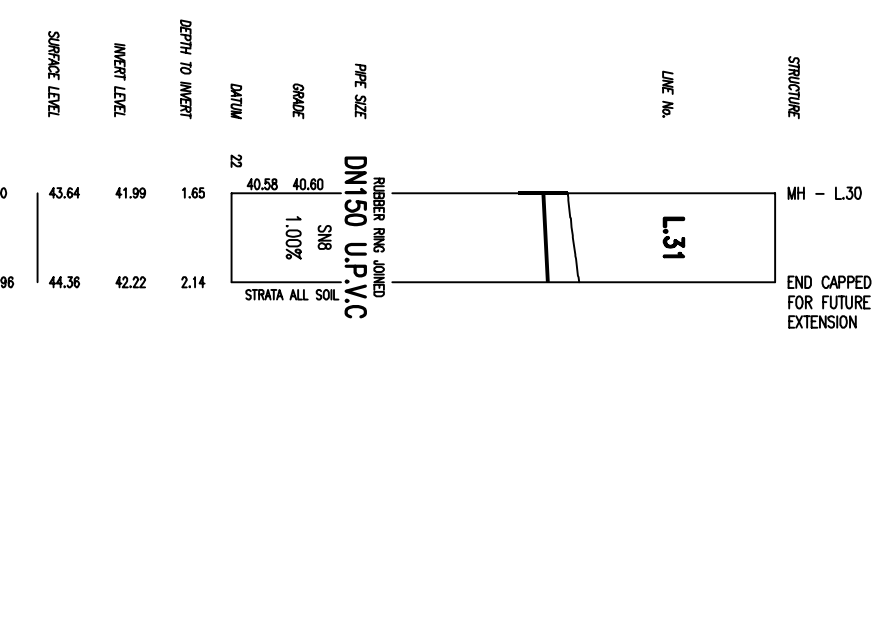
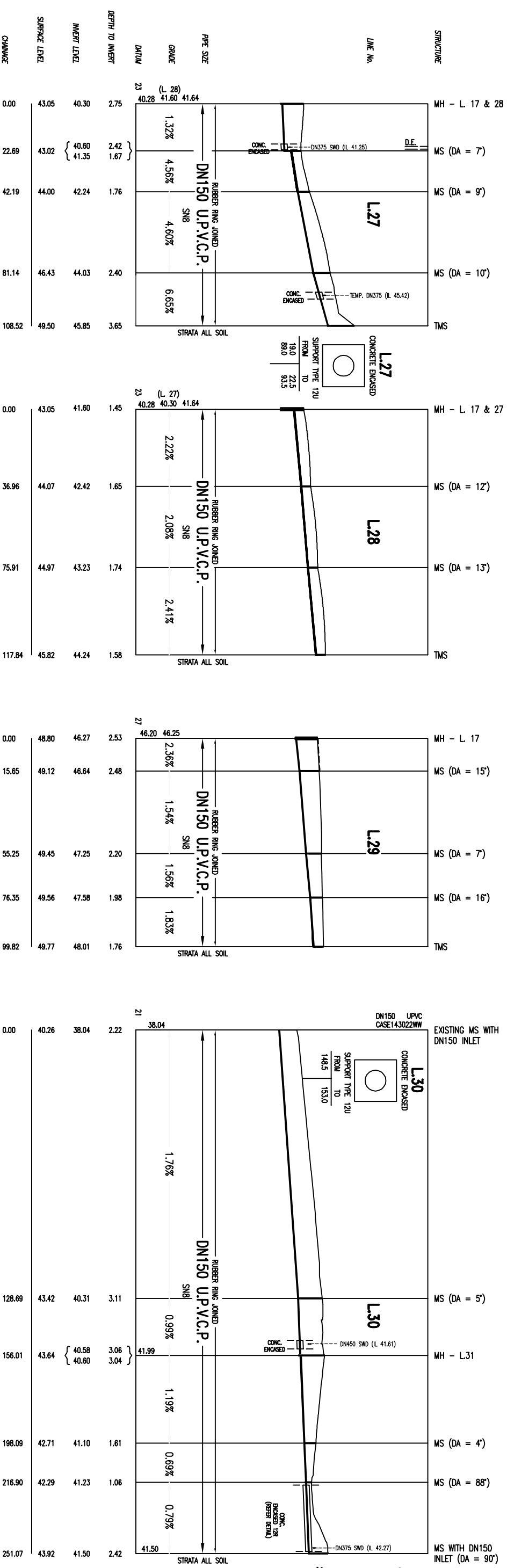

PLEASE NOTE SITE SPECIFIC
COMPACTION SPECIFICATION - SHEET 2
CONTACT DIAL BEFORE YOU DIG

No.	AMENDMENT DESCRIPTION	BY	DATE
01	ISSUED FOR REVIEW	D.Y.	06/04/17
02	ISSUE FOR TENDER	F.R.	23/05/17
03	ISSUE FOR REVIEW	D.Y.	04/09/17
04	ISSUE FOR STONEY WATER APPROVAL	A.S.	01/11/17
05	L3 & L28 DELETED & L5, L30, L27 AMENDED	F.R.	21/11/17
06	L3 & L30 AMENDMENTS	F.R.	26/02/18
07	WORK AS CONSTRUCTED	A.S.	14/09/18

WORK AS CONSTRUCTED CERTIFICATION		SYDNEY WATER CORPORATION	
DEVELOPER	NORTH RICHMOND JOINT VENTURE PTY LTD	REDBANK	YEOMENS
W.S.C.	QUALRE CONSULTING (NSW) PTY LTD		
CONSTRUCTOR	JONSHAW PTY LTD		
COMPLETED	13/09/2018		
W.A.C. PREPARED	14/09/2018		
DESIGNER	QUALRE CONSULTING (NSW) PTY LTD		
I CERTIFY THAT THE WORKS HAVE BEEN CONSTRUCTED IN ACCORDANCE WITH THE WORK AS CONSTRUCTED DRAWINGS			
FOR DETAILS OF SERVICES SEE SHEET 1			