

- POP** PRIVATELY OPERATED PAYPHONES
- APS** ASSISTANCE TELEPHONES (EG ELEVATOR AND ROADSIDE PHONES)
- MET** APPLY TO OTHER TYPE OF METERING POINT ( any service)
- ATM** ATM
- PRK** BANDSTAND / ROTUNDA / SPORTS FIELD STANDS / OTHER PARK BUILDING
- PSD** POINT OF SALE DEVICE (vending machine, ticket machine)
- TRF** Traffic Lights / Traffic Light Controller / Variable Speed Sign / Traffic Signal
- PBT** Public Transport (bus stop, tram stop, railway station, taxi rank, ferry wharf)
- SWT** Links / Link Pole / MV / HV Links / ABC Links / Dynamic Switch / Airbrake Switch / Isolator
- WAT** Water Infrastructure (storage, pumps, valves water supply, waste water, sewerage stations)
- GAS** Natural Gas Infrastructure
- CAM** Camera (security / traffic)
- CTL** Bridge control, swing bridge, traffic control gates, railway boom gates)
- MOB** Mobile Phone Tower / radio antenna
- LIT** Street Lighting Pole / street light controller
- CAR** Unmanned (council) car park
- PWR** Transformer / Kiosk / Pad Mount Sub-station / Pole Mount Transformer
- NAP-ID** Network Access Point (NAP)
- MPT-ID** Multipoint (MPT)  
n is the number of ports (eg 4,6,8,12)

- TJL-ID** Splice Joint on a Transit Cable (TJL)
- DJL-ID** Splice Joint on a Distribution Cable (DJL)
- LJL-ID** Splice Joint on a Local Cable (LJL)
- MJL-ID** Splice Joint on a Tether Cable (MJL)
- AJL-ID** Zone Terminal / Splice Joint (AJL)
- FDH-ID** Fibre Distribution Hub-FDH Cabinet with Cabinet ID shown
- PIT-ID 2** Service Drop Access Pit (650mmX280mmX565mm)
- PIT-ID 5** Network Boundary/Local Network Pit (Single Lid) (700mmX450mmX650mm)
- PIT-ID 6** Distribution/Local Network Connection Pit (Dual Lid) (1360mmX555mmX650mm)
- PIT-ID 8** Distribution/Local Network Connection Pit (1360mmX555mmX860mm)
- PIT-ID 9** Fibre Distribution Hub (FDH) Pit (2000mmX555mmX900mm)
- Existing Telstra manhole
- Existing Telstra Pit ( 2,3,4,5,6,7,8,9 )
- Telstra exchange
- Example of Telstra Major Conduit Layout with Proposed duct marked to be used by NBN
- M** < - > NBN MARKER POST  
MARKER POST TO BE NUMBERED
- DES QTY** Example of descriptor box that will show the type of work and the quantity involved
- PCD** Premise Connection Device (PCD)
- POLE-ID** Pole (showing pole identity)
- FAN** Fan Access Node site (FAN)
- 138A** <sup>RX</sup> <sub>CX</sub> Multi Dwelling Unit (MDU)

**DEPTH** ---  
**ALIGN** ---

DEPTH OVER ALIGNMENT SYMBOL TO BE USED WITH EVERY MARKER POST

Symbol to be used when replacing/removing existing network

CABLE TRAY:

### CONDUIT CONFIGURATION

CONDUITS AND DUCTS ARE IN LAYER :  
< L460 NBN Support - Underground >  
AND TERMINOLOGY CATEGORIZED INTO TWO GROUPS IN THE DRAWING AS PER BELOW:

1- DUCT USED WITH LOCAL NETWORK  
2-CONDUIT USED WITH LEAD-IN DROPS  
ATTRIBUTES ATTACHED ARE AS SHOWN

CONDUIT SIZE: PIT-ID 9 P100  
CONDUIT LENGTH: 26.5  
PIT-ID 5

### CABLE CONFIGURATION

CABLE TYPE:  
CABLES DIVIDE INTO FOLLOWING CATEGORIES AND ARE COLOUR CODED:

TRANSIT CABLES	COLOUR NO: 1	312F
DISTRIBUTION CABLES	COLOUR NO: 190	288F
LOCAL CABLES	COLOUR NO: 4	144F
TETHER CABLES	COLOUR NO: 3	12F
LEAD IN (DROP) CABLES	COLOUR NO: 5	1F

CABLE SIZE:  
CABLE SIZE IS THE TOTAL NUMBER OF OPTIC FIBRES IN THE CABLE AND IS DETERMINED BY A NUMBER FOLLOWED BY F (FIBRE) OR R (RIBBON) IN THE MIDDLE OF THE LINE TYPE

LINE TYPES ARE CATEGORIZED INTO 3 TYPES:  
1- IN-CONDUIT: DXXXF 312F ...  
2- AERIAL: DXXXF\_A 144\_A ...  
3- BURIED: DXXXF\_B 12\_B ...

CABLE LOCATION:  
CABLE LOCATIONS DETERMINES WHERE THE CABLE IS USED AS PER BELOW:

IN-CONDUIT	288F
AERIAL	144F
BURIED	96F

EXAMPLE:  
144 FIBRE AERIAL LOCAL CABLE — 144F —  
1 FIBRE BURIED DROP CABLE — 1F —  
432 FIBRE IN-CONDUIT TRANSIT CABLE — 48F —

— FSA Boundary  
— FSAM Boundary  
— FDA Boundary

**STAFF WORKING ON THIS ESTIMATE PLEASE NOTE:**  
The location of other authorities services which may affect this work have not been obtained by the estimator. Constructor to obtain service information before commencing.

**DANGER LASER BEAM**  
EYE PROTECTION MUST BE WORN

**SAFETY FIRST**  
SAFETY STARTS WITH YOU



REV	DATE	DRAFTER	DESCRIPTION	APPROVED
C	15/11/2018	CIPRIAN PASCU	AS BUILT	
B	01/05/18	CIPRIAN PASCU	FOR CONSTRUCTION	
A	25/03/2018	CIPRIAN PASCU	PRELIMINARY	

**STRICTLY CONFIDENTIAL**

NBNCO APPROVAL RECORD:

SIGNATURE	DATE
<input type="checkbox"/> DD	_____
<input type="checkbox"/> WD	_____
<input type="checkbox"/> AB	_____

QUALITY RECORD :

NBNCO DISCLAIMER  
THIS DOCUMENT HAS BEEN PREPARED SOLELY FOR THE USE OF NBNCO LIMITED (ABN 86 136 533 741) FOR USE IN MAINTAINING NBNCO FACILITIES. IT HAS NOT BEEN CREATED FOR ANY OTHER USE. IT SHOULD NOT BE SCALED TO LOCATE NBNCO ASSETS. NO WARRANTY IS GIVEN THAT THE INFORMATION IS ACCURATE OR COMPLETE.

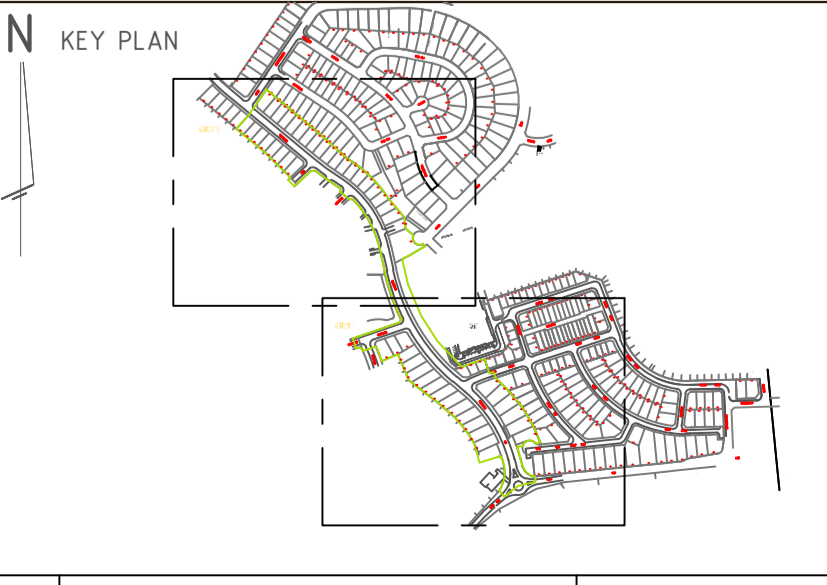
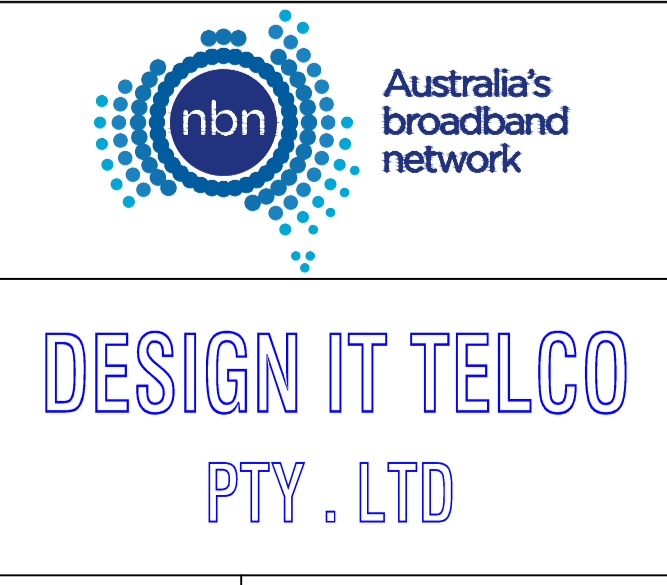

DRAWING TITLE:  
53 LOTS SUBDIVISION - PIT & PIPE PROJECT  
YEOMANS NORTH ENTRY ROAD, NORTH RICHMOND  
"REDBANK ESTATE"

STATE: NSW	REGION:
FSA:	SAM: ADA:
PROJECT No: AYCA-5ALZAT	
CADREF No: PN 33153	
SCALE N/A	SHEET No. OF REV. C

# SHEET 1

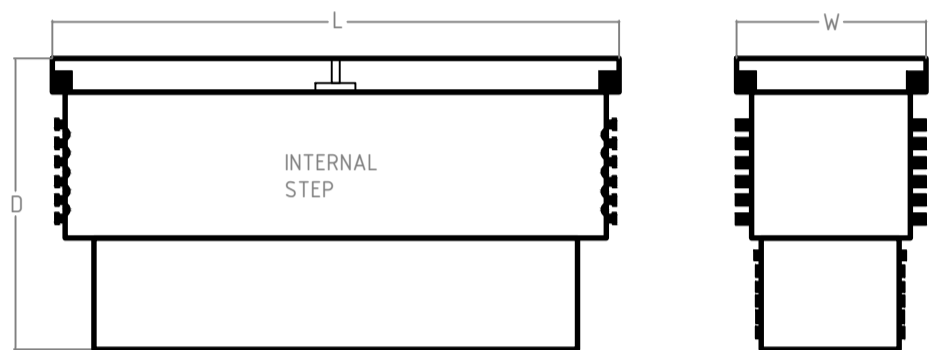
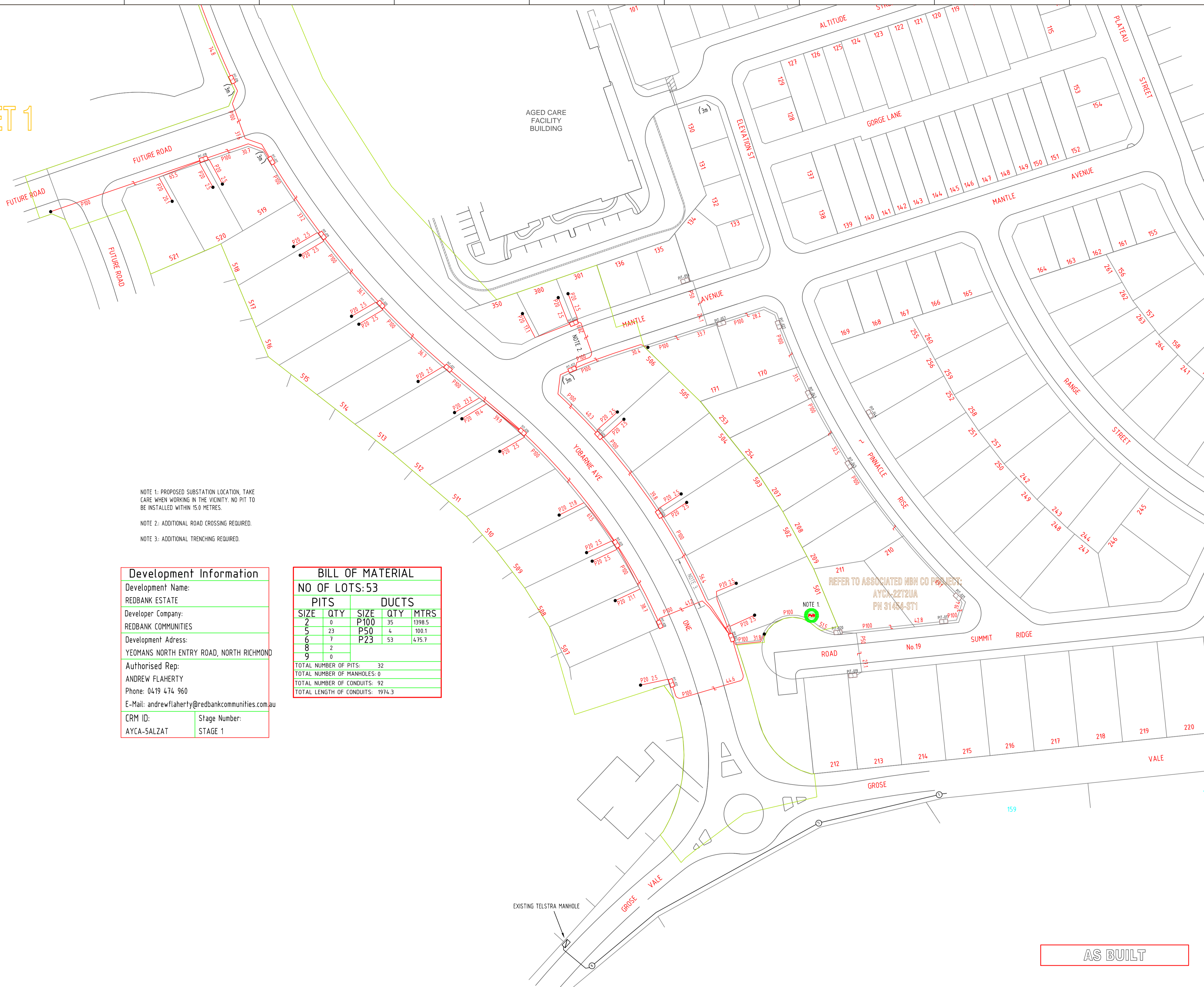

NBN NOMINAL DIMENSIONS (mm)			
PIT TYPE	L	W	D
Local Network Pit/Network Boundary Pit	700	450	650
Local Network Connection Pit	1360	555	860
Distribution Pit	1360	555	860
FDH PIT	2000	555	900

NOTE 1: PROPOSED SUBSTATION LOCATION, TAKE CARE WHEN WORKING IN THE VICINITY. NO PIT TO BE INSTALLED WITHIN 15.0 METRES.

NOTE 2: ADDITIONAL ROAD CROSSING REQUIRED.

NOTE 3: ADDITIONAL TRENCHING REQUIRED.

**Development Information**

Development Name:  
REDBANK ESTATE

Developer Company:  
REDBANK COMMUNITIES

Development Address:  
YEOMANS NORTH ENTRY ROAD, NORTH RICHMOND

Authorised Rep:  
ANDREW FLAHERTY  
Phone: 0419 474 960  
E-Mail: andrewflaherty@redbankcommunities.com.au

CRM ID: AYCA-5ALZAT      Stage Number: STAGE 1

BILL OF MATERIAL				
NO OF LOTS: 53				
PITS		DUCTS		
SIZE	QTY	SIZE	QTY	MTRS
2	0	P100	35	1398.5
5	23	P50	4	100.1
6	7	P23	53	475.7
8	2			
9	0			
TOTAL NUMBER OF PITS:		32		
TOTAL NUMBER OF MANHOLES:		0		
TOTAL NUMBER OF CONDUITS:		92		
TOTAL LENGTH OF CONDUITS:		1974.3		

**TYPICAL ROAD CROSSING CONFIGURATION**  
OFFSET FROM ELECTRICAL DUCTS TO ALLOW FOR SIDE ENTRY INTO PIT & CORRECT PIT PLACEMENT ON BOUNDARY.

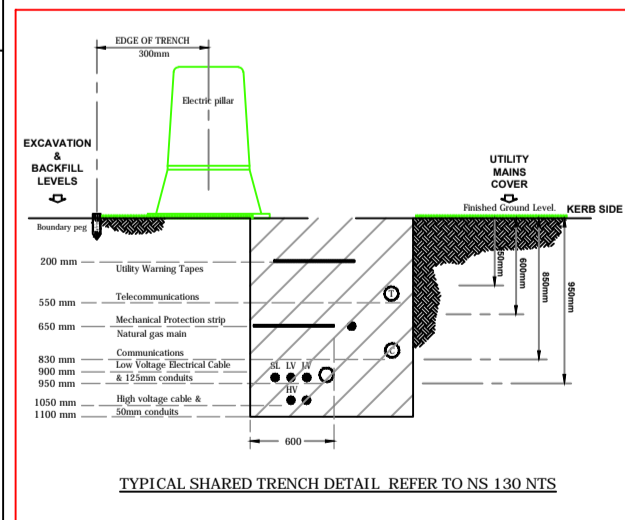
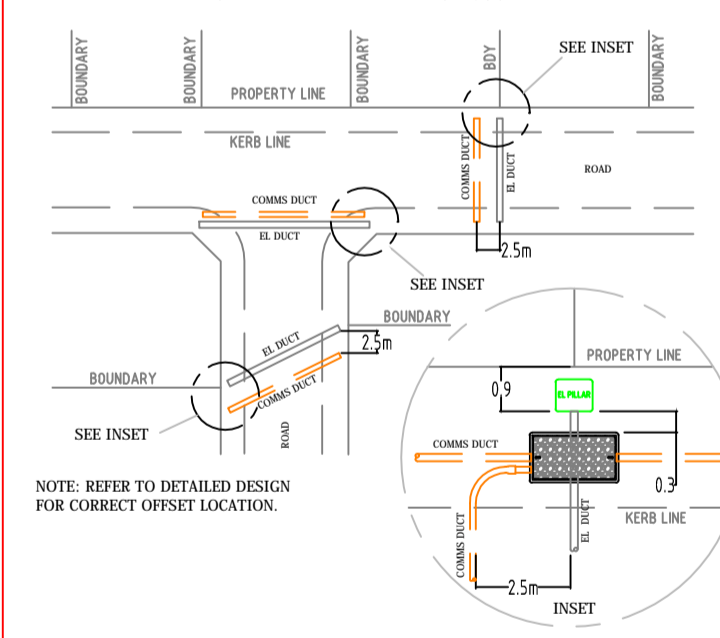

DESIGN & CONSTRUCTION AS PER NBN GUIDELINES DOCUMENT. \*INSTALLING PIT AND CONDUIT INFRASTRUCTURE - GUIDELINES FOR DEVELOPERS - 08/07/2013

CIVIL CONTRACTORS ARE NOT TO LINK INTO EXISTING TELSTRA OR OTHER SERVICE PROVIDER NETWORK. NEW NETWORKS WILL BE LINKED UNDER FUTURE PROJECT. PIT AND PIPE ONLY WITH-IN THE DEVELOPMENT

**AS BUILT**



REV	DATE	DRAFTER	DESCRIPTION	APPROVED
C	15/11/2018	CIPRIAN PASCU	AS BUILT	
B	01/05/18	CIPRIAN PASCU	FOR CONSTRUCTION	
A	25/03/2018	CIPRIAN PASCU	PRELIMINARY	

**STRICTLY CONFIDENTIAL**

NBNC APPROVAL RECORD:

SIGNATURE	DATE
<input type="checkbox"/> DD	_____
<input type="checkbox"/> WD	_____
<input type="checkbox"/> AB	_____

QUALITY RECORD:

NBNC DISCLAIMER  
THIS DOCUMENT HAS BEEN PREPARED SOLELY FOR THE USE OF NBNC LIMITED (ABN 86 136 533 741) FOR USE IN MAINTAINING NBNC FACILITIES. IT HAS NOT BEEN CREATED FOR ANY OTHER USE. IT SHOULD NOT BE SCALED TO LOCATE NBNC ASSETS. NO WARRANTY IS GIVEN THAT THE INFORMATION IS ACCURATE OR COMPLETE.

**DESIGN IT TELCO PTY. LTD**

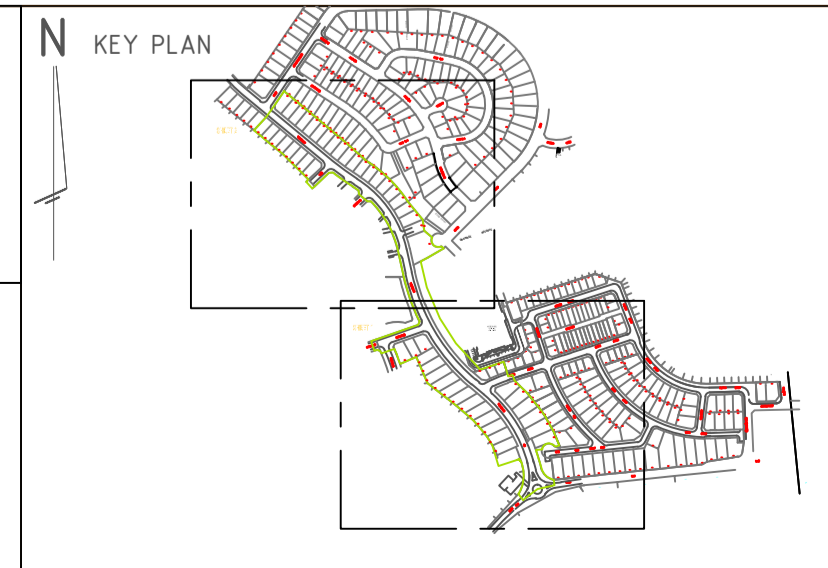

DRAWING TITLE:  
53 LOTS SUBDIVISION - PIT & PIPE PROJECT  
YEOMANS NORTH ENTRY ROAD, NORTH RICHMOND  
"REDBANK ESTATE"

STATE: NSW	REGION:
FSA:	SAM: ADA:
PROJECT No: AYCA-5ALZAT	
CADREF No: PN 33153	
SCALE: N/A	SHEET No. 1 OF 2 REV. C

# SHEET 2



REFER TO ASSOCIATED NBN CO PROJECT:  
AYCA-225VFN  
PN 31454-6T3B

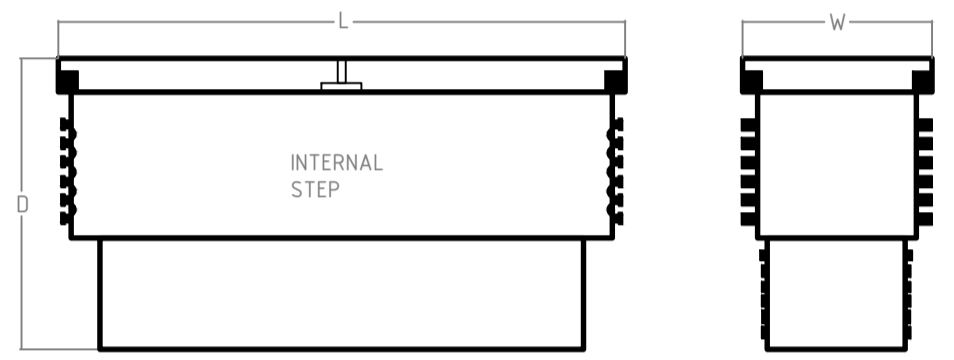

NBN NOMINAL DIMENSIONS (mm)			
PIT TYPE	L	W	D
Local Network Pit/Network Boundary Pit	700	450	650
Local Network Connection Pit	1360	555	860
Distribution Pit	1360	555	860
FDH PIT	2000	555	900

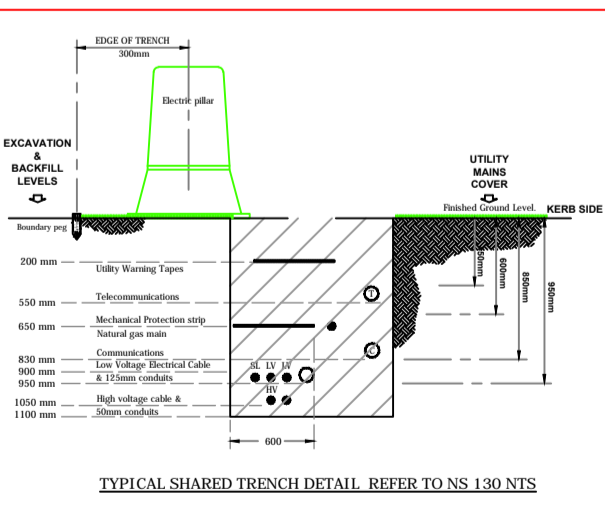
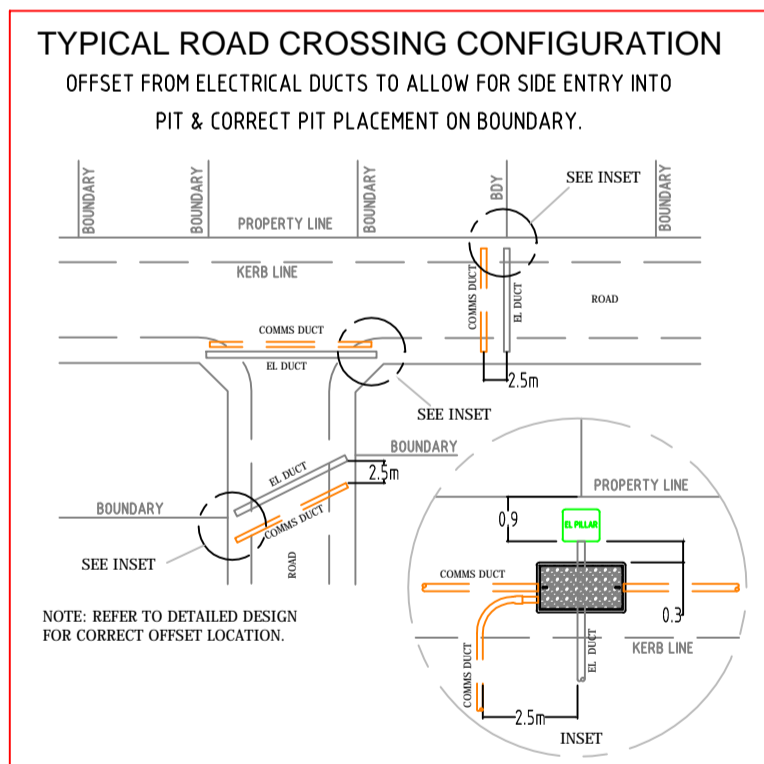

DESIGN & CONSTRUCTION AS PER NBN GUIDELINES DOCUMENT. \*INSTALLING PIT AND CONDUIT INFRASTRUCTURE - GUIDELINES FOR DEVELOPERS - 09/07/2013

CIVIL CONTRACTORS ARE NOT TO LINK INTO EXISTING TELSTRA OR OTHER SERVICE PROVIDER NETWORK. NEW NETWORKS WILL BE LINKED UNDER FUTURE PROJECT. PIT AND PIPE ONLY WITH-IN THE DEVELOPMENT

AS BUILT



REV	DATE	DRAFTER	DESCRIPTION	APPROVED
C	15/11/2018	CIPRIAN PASCU	AS BUILT	
B	01/05/18	CIPRIAN PASCU	FOR CONSTRUCTION	
A	25/03/2018	CIPRIAN PASCU	PRELIMINARY	

**STRICTLY CONFIDENTIAL**

NBNCO APPROVAL RECORD:

<input type="checkbox"/> DD	SIGNATURE	DATE
<input type="checkbox"/> WD		
<input type="checkbox"/> AB		

QUALITY RECORD:

NBNCO DISCLAIMER  
THIS DOCUMENT HAS BEEN PREPARED SOLELY FOR THE USE OF NBNCO LIMITED (ABN 86 136 533 741) FOR USE IN MAINTAINING NBNCO FACILITIES. IT HAS NOT BEEN CREATED FOR ANY OTHER USE. IT SHOULD NOT BE SCALED TO LOCATE NBNCO ASSETS. NO WARRANTY IS GIVEN THAT THE INFORMATION IS ACCURATE OR COMPLETE.

**DESIGN IT TELCO PTY. LTD**

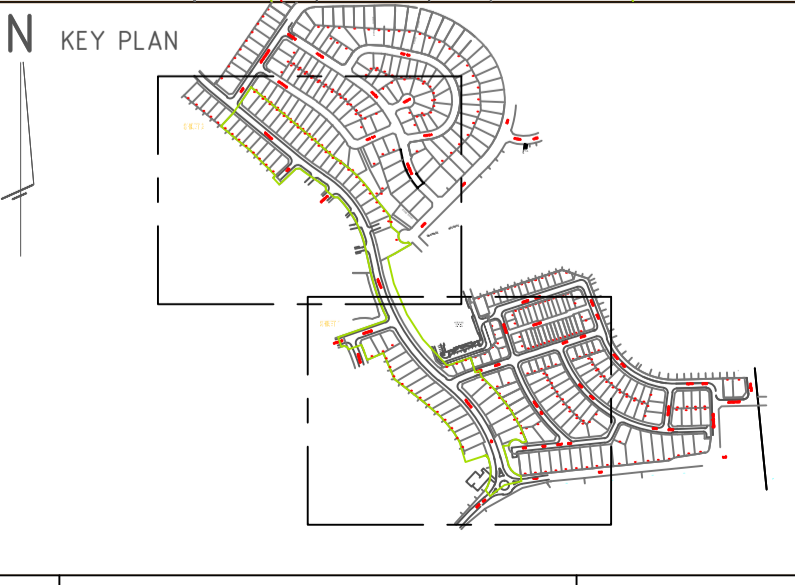

DRAWING TITLE:  
53 LOTS SUBDIVISION - PIT & PIPE PROJECT  
YEOMANS NORTH ENTRY ROAD, NORTH RICHMOND  
"REDBANK ESTATE"

STATE: NSW	REGION:
FSA:	SAM: ADA:
PROJECT No: AYCA-5ALZAT	
CADREF No: PN 33153	
SCALE: N/A	SHEET No. 2 OF 2 REV. C